

SERAC® XHM12
Screw unit with integrated anti-rotation device and travel measurement

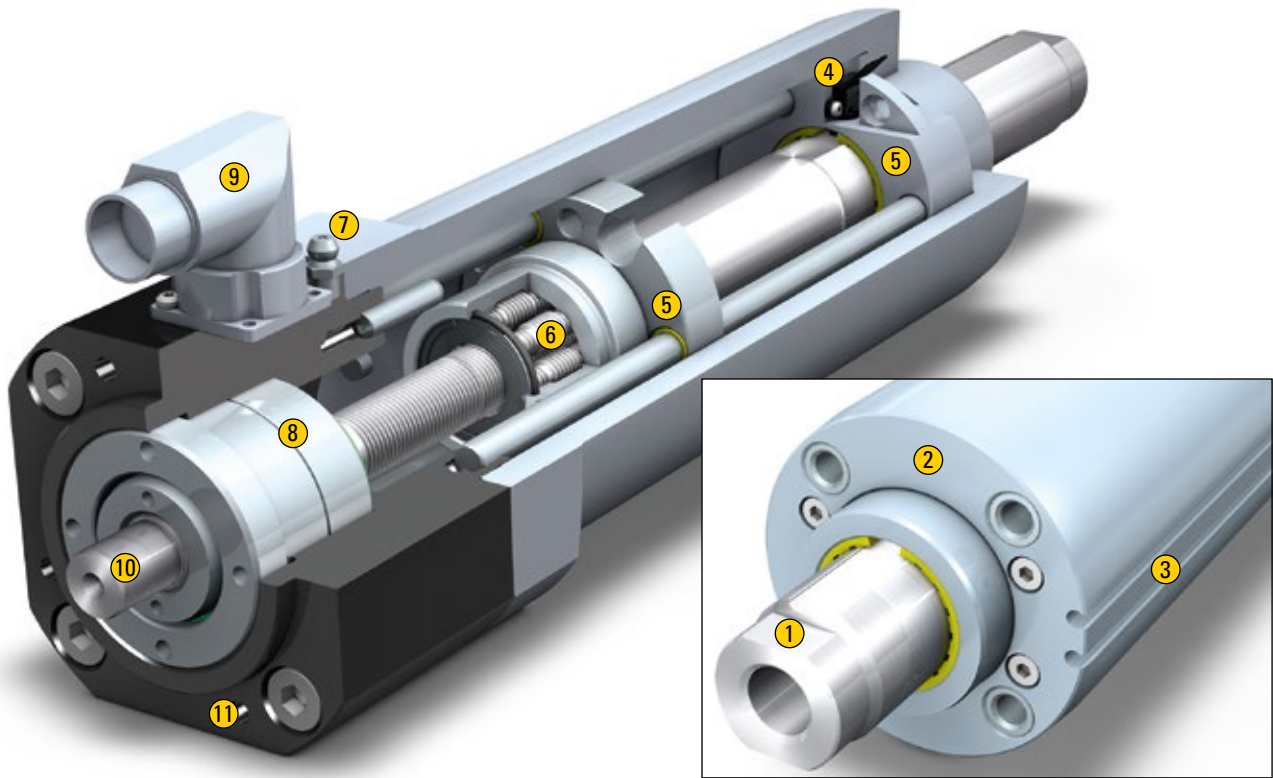

- 1 Output rod end with internal thread (M16)
- 2 Mounting flange with tapped holes (M8)
- 3 Optional safety limit switches
- 4 Direct travel measurement for maximum positioning accuracy under load
- 5 Integrated stable anti-rotation device
- 6 ASCA servo screw
- 7 Lubricating nipple for ASCA servo spindle
- 8 Play-free bearing assembly
- 9 Electrical connection (travel measurement)
- 10 Shaft end for motor coupling
- 11 Tapped hole for motor adapter